

The Pool CleanerTM

NOW WITH

3+3
WARRANTY
3 YEARS FULL + 3 YEARS PRO RATA

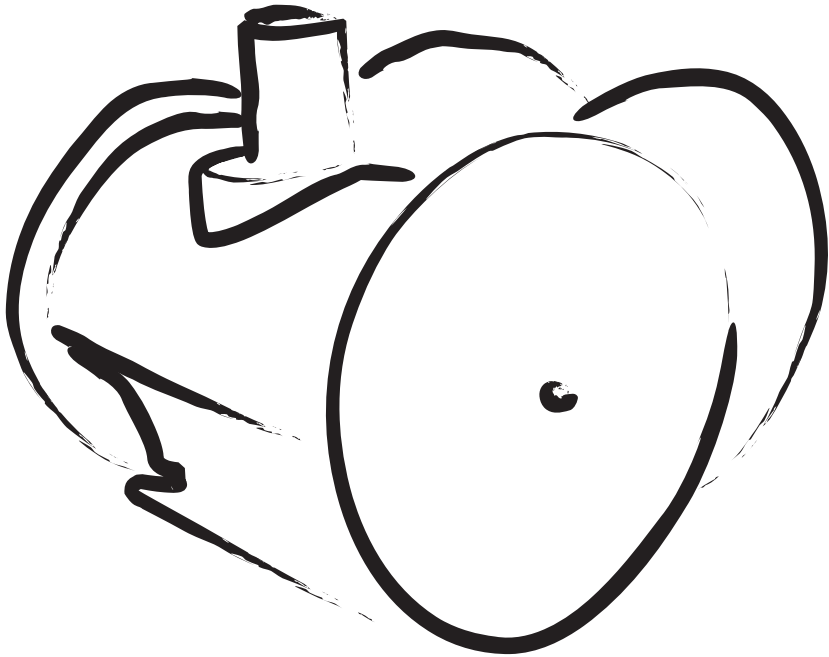

OWNERS MANUAL 2 WHEEL and 4 WHEEL SUCTION-SIDE POOLCLEANERS

MADE IN THE USA by POOLVERGNUEGEN

AUSTRALIAN & NEW ZEALAND DISTRIBUTOR

www.linc.com.au



IMPORTANT FACTS

- ⌘ The POOLCLEANER™ should **NEVER** be used to remove plaster debris in new pools.
- ⌘ **ALWAYS** remove the POOLCLEANER™ before you chemically shock your pool.
- ⌘ **ALWAYS** remove the POOLCLEANER™ when swimmers enter the pool.
- ⌘ When removed from the pool, store the POOLCLEANER™ in a shaded safe area.
- ⌘ When removed from pool **DO NOT** coil the hoses.
THEY MUST BE STORED STRAIGHT.
- ⌘ The POOLCLEANER™ is **NOT** a toy and not intended for children.
- ⌘ Keep the POOLCLEANER™ and hoses away from chewing pets.
- ⌘ **REMOVE** the POOLCLEANER™ when performing backwash.
- ✕ **REMEMBER SAFETY FIRST**

INCLUDED COMPONENTS

2 WHEEL MODEL

- 1 2 X SUCTION POOLCLEANER™
- 10 SECTION OF HOSE
- 1 LEADER HOSE (grey cuff)
- 1 FLOAT (2 halves)
- 1 HOSE CONE
- 1 90° CONNECTOR
- 1 REGULAR VALVE

4 WHEEL MODEL

- 1 4 x SUCTION POOLCLEANER™
- 11 SECTIONS OF HOSE
- 1 LEADER HOSE (grey cuff)
- 1 FLOAT (2 halves)
- 1 HOSE CONE
- 1 90° CONNECTOR
- 1 REGULATOR VALVE

INSTALLING THE POOLCLEANER

STEP 1 Preparing your spa . . .

1. Make sure your chemical balance is correct. If not, now is the time to correct it. If you chemically shock the spa, wait a day or two before continuing.
2. Point all your return fittings downward.

POINT RETURN FITTINGS DOWN

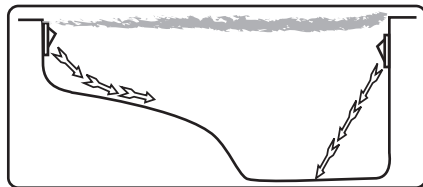

STEP 2 Connecting the hoses . . .

1. Take the Leader Hose (the one with the grey cuff) and attach the 2 snap on floats, snap them at 50cm to 60cm from the grey cuff. This is the section of hose that attaches to the POOLCLEANER™ in Step 3.

Grey Cuff

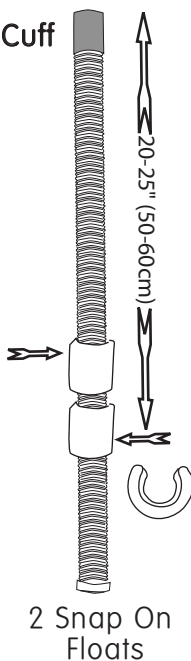

2. Connect hose to filter canister.

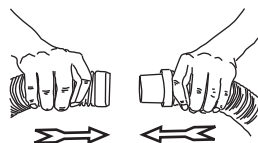

3. Connect all the hoses (except the Leader Hose). Connect male to female. If need be, wet the hoses for easier assembly. Now connect Leader Hose to the end.
4. The connected hoses should be one to two lengths longer than the furthest point from the skimmer.

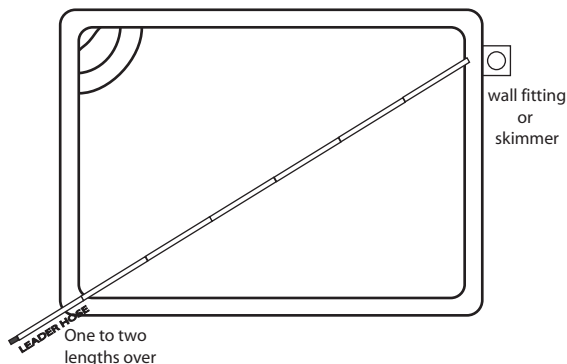

INSTALLING THE POOLCLEANER cont.

STEP 3 Attaching the PoolCleaner . . .

1. Connect the POOLCLEANER™ to the grey cuff end on the leader hose.

STEP 4 Getting your PoolCleaner wet . . .

With the pump turned off, lower the POOLCLEANER™ and then vertically push the hose down into the water until the hose is completely filled with water.

YOU DO NOT WANT ANY AIR TO REMAIN IN THE HOSE AND THE POOLCLEANER™!!

Connect filter to between first and second hose from skimmer box.

STEP 5 Spa Fitting . . .

1. Connect the hose to the 90 degree elbow or hose adaptor.
See chart below.

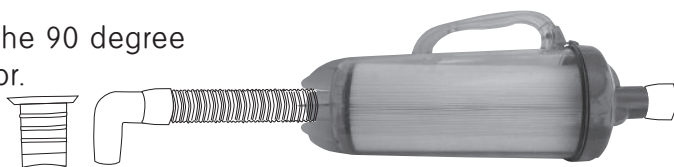
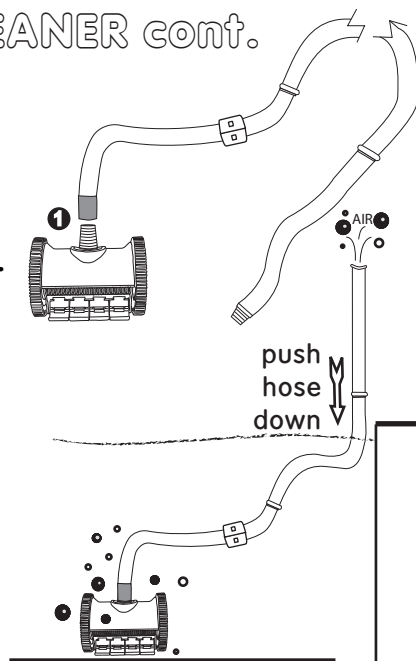

Brand	Model	Filters	Vacuum Fitting	Elbow/Hose Adaptor
Bullfrog	454	Top Load	Top Load Type	Elbow
	251	Top Load	Top Load Type	Elbow
	252	Top Load	Top Load Type	Elbow
	254	Top Load	Top Load Type	Elbow
Cyclone	Swim	Top Load	Top Load Type	Elbow
	Super Swim	Top Load	Top Load Type	Elbow
Designer	X-Stream 126	Front Load	Front Load Type	Elbow
	X-Stream 333	Front Load	Front Load Type	Hose Adaptor
	X-Stream 659	Front Load	Front Load Type	Hose Adaptor
Signature	V-Stream I	Front Load	Front Load Type	Elbow
	V-Stream II	Front Load	Front Load Type	Hose Adaptor
	V-Stream III	Front Load	Front Load Type	Hose Adaptor
	Aquazone I	Top Load	Top Load Type	Elbow
	Aquazone II	Top Load	Top Load Type	Elbow
	Aquazone III	Top Load	Top Load Type	Elbow
	W-Stream	Top Load	Top Load Type	Elbow
Leisurerite	My Win Swim	Top Load	Front Load Type	Elbow
	My Win Pro	Top Load	Front Load Type	Elbow
	My Win Expert	Top Load	Front Load Type	Elbow
	My Victory Swim	Top Load	Front Load Type	Elbow
	My Victory Pro	Top Load	Front Load Type	Elbow
	My Victory Expert	Top Load	Front Load Type	Elbow

PREPARING YOUR SKIMMER

REPLACE CARTRIDGES WITH VACUUM FITTINGS HOW TO REMOVE FILTER CARTRIDGES

1. Make sure Spa Power is off.
2. TOP LOAD: Remove Skimmer lid by pulling up vertically.

FRONT LOAD: Remove Skimmer face by pulling up vertically.
3. FRONT LOAD: Remove Leaf Tray by sliding out forwards.
4. TOP LOAD: Unscrew Filter Cartridges by rotating anti-clockwise.

FRONT LOAD: Unscrew Filter Cartridges by rotating anti-clockwise and lift up and pull out of filter box.

5. Submerge vacuum fittings into the spa first to remove trapped air bubbles prior to inserting Vacuum Fittings into Skimmer box.
6. Install Vacuum Fittings by rotating clockwise, making sure not to over tighten.
7. Connect elbow or hose adaptor to open end of vacuum fitting.
8. TOP LOAD: Replace Skimmer lid by locating into the recess and push down until it clicks into place.

FRONT LOAD: Leave the Leaf Tray and the Skimmer Face off.

9. Power on Spa and run Spa in Filter Cycles.

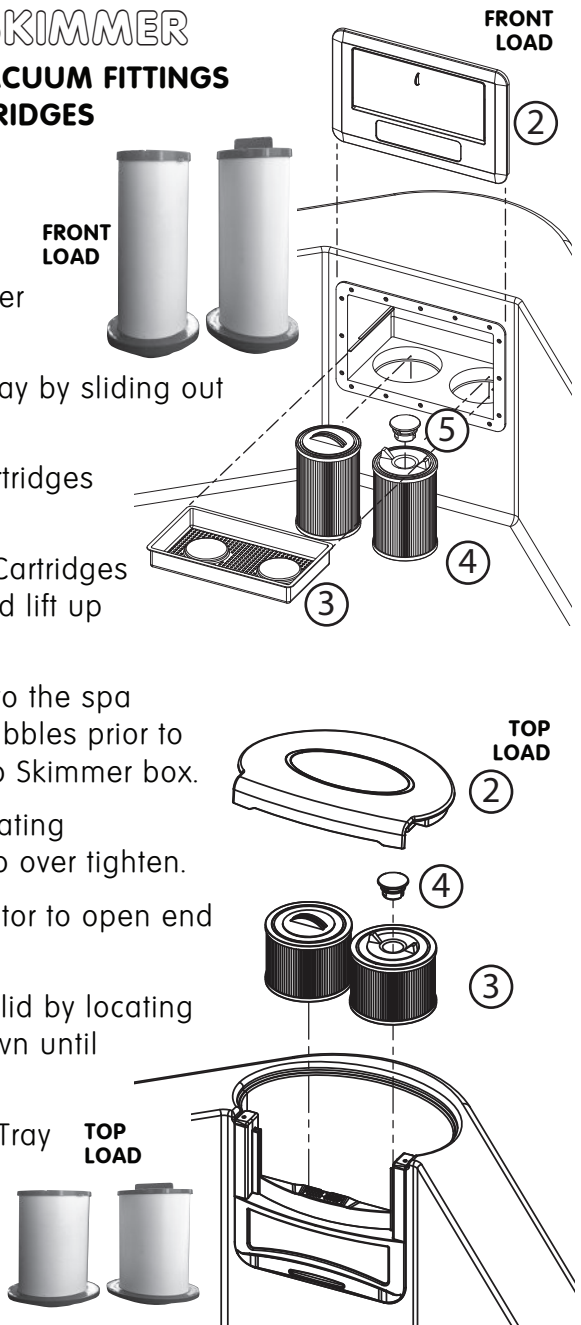

NOTE: Failure to remove air bubbles in the Filters can induce an airlock into the plumbing system, this will cause the pump and heater to operate incorrectly. To ensure there are no airlocks, simply loosen the barrel unions to the pump and heater to release any trapped air and then re-tighten (when conducting this procedure, ensure the Spa Power is OFF).

GETTING STARTED

PoolCleaner™ should operate at minimum 8 RPM.

While the PoolCleaner™ is running take it by the leader hose so that the PoolCleaner™ is just below the water. (KEEP THE CLEANER BELOW THE WATER LEVEL or else it will suck air).

Now count the number of revolutions made per minute by the RIGHT WHEEL by using the hump (raised treads) as your marker. If it is above 8 RPM you are done.

If it is below 8 RPM check troubleshooting.

NOTE: This is equivalent to 7 to 10 inches (18-25cm) of mercury on a vacuum gauge. A vacuum gauge is NOT included with the PoolCleaner™ but is available at your local pool store.

Count RPM here
at the hump on the
RIGHT FRONT WHEEL

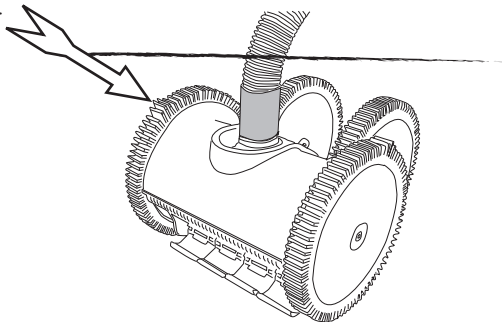

**KEEP THE POOLCLEANER
BELOW THE WATER LEVEL !!!**

SERVICING YOUR POOL CLEANER

(Removal of obstruction or turbine vane replacement)

BEFORE YOU DO ANYTHING, TURN THE PUMP **OFF**. SUCTION CAN BE DANGEROUS!

1. **Remove the PoolCleaner™ from the pool, making sure to place the hoses straight.** Separate the PoolCleaner™ from the Leader Hose.

2. First we will check to see if anything is clogged inside the PoolCleaner™. Rotate the RIGHT FRONT wheel forward (the grill is the front). If it won't move, there is an obstruction. If it moves smoothly there probably is no obstruction.

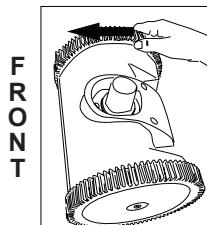

3. Place the cleaner on a work surface. You will need a Phillips screwdriver. Remove the three screws that hold the Shroud (Top Cover) and remove the Shroud. Set the screws and Shroud aside.

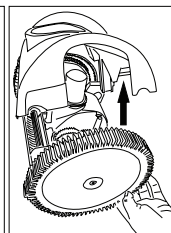
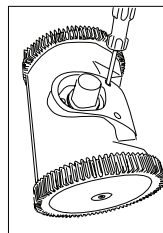

4. Remove the Turbine Cover. The Turbine Cover fits tightly so you may have to wiggle it a little. If need be, remove the vanes by sliding them out horizontally. Should there be any obstruction, remove it. When you reinsert the vanes, make sure that they fold forward, toward the front of the cleaner (the grill). Also make sure that you don't insert the worn side of the vanes into the turbine hub as this would cause them to fall out.

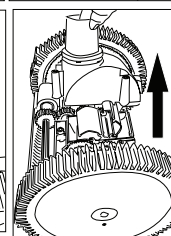
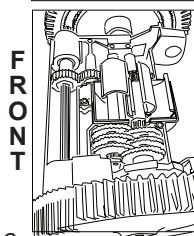

5. Replace the Turbine cover making sure it is on correctly. Now visually inspect the rest of the cleaner removing any debris that may be in gears, drive shafts etc. **BEFORE PLACING THE SHROUD BACK ON, REPEAT STEP 2 (turning the right wheel) to make sure the PoolCleaner™ runs smoothly.** If it doesn't

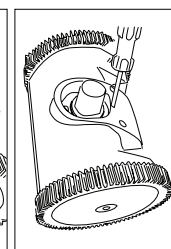
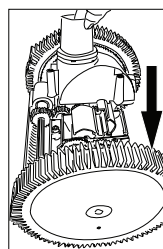

turn, you may have replaced the vanes incorrectly. Place the Shroud back onto the PoolCleaner™ making sure it's on correctly. Drop the three screws into the screw holes and secure.

SERVICING YOUR POOLCLEANER

(Changing tyres on your PoolCleaner™)

BEFORE YOU DO ANYTHING, TURN THE PUMP **OFF**. SUCTION CAN BE DANGEROUS!

1. **Remove the PoolCleaner™ from the pool, making sure to place the hoses straight.** Separate the PoolCleaner™ from the Leader Hose.
2. The tyres **must** be replaced when the tyres are worn down to the tread wear indicators!
3. Place the cleaner on a work surface. To remove the 2X PoolCleaner™ tyres, using only your hands (other objects may damage the PoolCleaner™) simply fold the tyre off from top to bottom.
4. Place the Shroud back onto the PoolCleaner™ making sure it's on correctly. Drop the three screws into the screw holes and secure.

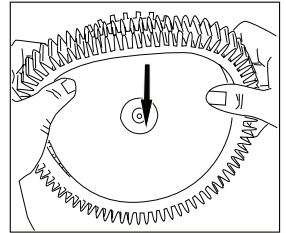
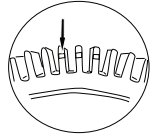

TROUBLESHOOTING YOUR POOLCLEANER

PROBLEM

SOLUTION

The PoolCleaner does not move.

- ★ The pump may be turned off.
- ★ The pump may not be primed. Check for leaks in the system (symptoms -- bubbles from the returns ?)
- ★ Problem or obstruction in the system.
- ★ Cart Needs cleaning.
- ★ Skimmer plugs installed correctly.
- ★ Pump impeller may be blocked (see pump manual).
- ★ Obstruction in the PoolCleaner itself. See pg 9 to clear.

The PoolCleaner moves too slow.
(see also "does not move" above)

- ★ Problem or obstruction in the system.
- ★ Obstruction in the PoolCleaner itself.
- ★ Low wheel RPM (insufficient flow). See pg 7 to adjust.

The right wheel will not turn when rotated by hand.

- ★ Obstruction in the PoolCleaner itself. See pg 9 to clear.

The loops in the hoses won't come out.

- ★ The hoses have been stored in a coiled position. Lay them straight in the sunlight.
- ★ Clean swivel on cleaner head by running it under a tap.

The PoolCleaner does not clean the entire pool.

- ★ The hose is too short. See pg 4. Step 2
- ★ The float(s) may be in the wrong position. See pg 4. Step 2
- ★ The Hose Cone Swivel (on the turbine cover) may be dirty. Clean it.
- ★ The return fittings may be pushing the PoolCleaner hoses away. Point them down. See pg 4. Step 1

The PoolCleaner climbs the wall too much or climbs out.

- ★ The tire treads and skirts may be worn down.
- ★ Too much suction or flow. See pg 6 to adjust.

The PoolCleaner won't climb the wall. (see also "moves too slow" above)

- ★ Too little suction or flow. See pg 7 to adjust.
- ★ Float may be in the wrong position. See pg 4. Step 2

The hoses leak.

- ★ An animal may have bitten into the hose.

The PoolCleaner falls on its side and takes too long to recover.

- ★ The float(s) may be in the wrong position. See pg 4. Step 2
- ★ The hose is too short. See pg 4. Step 2
- ★ The return fittings may be pushing the PoolCleaner hoses away. Point them down. See pg 4. Step 1

**ALWAYS TURN OFF THE SYSTEM BEFORE PERFORMING ANY REPAIRS.
ALWAYS REMOVE THE POOLCLEANER AND TURN OFF SYSTEM BEFORE
SWIMMERS ENTER THE POOL. REMEMBER SAFETY FIRST !!!**

EXPLODED VIEWS

2 WHEEL POOLCLEANER

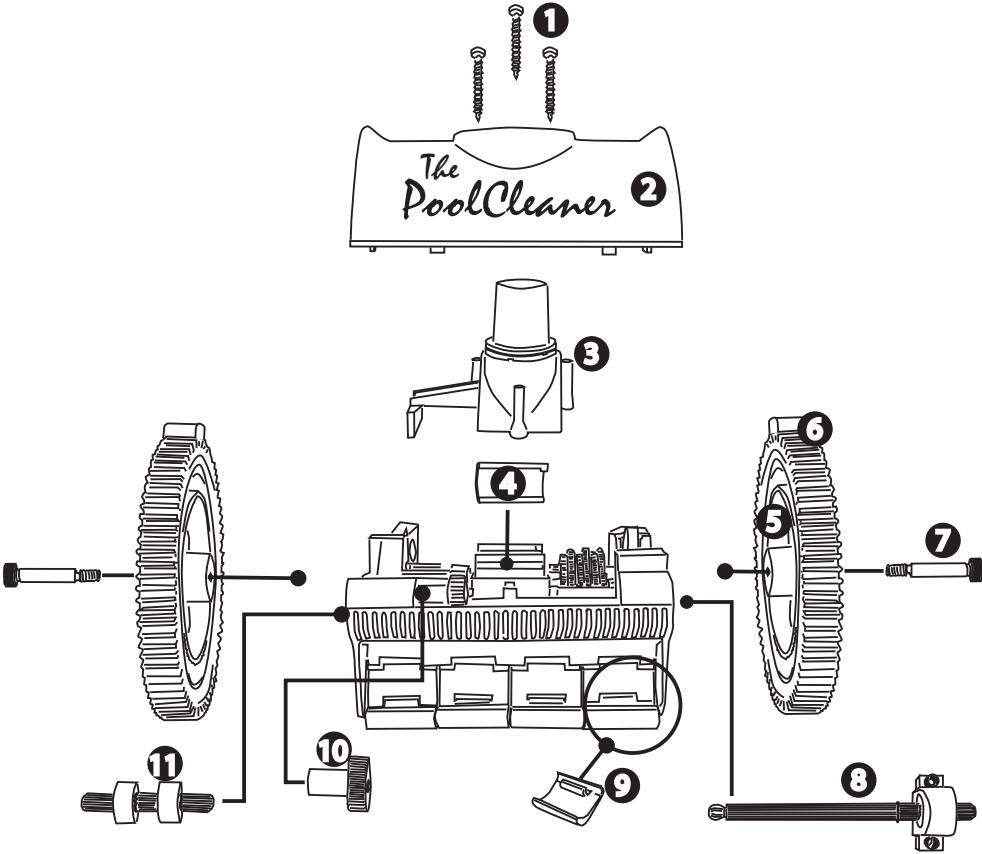

THE POOL CLEANER - WARRANTY

The Three Year Comprehensive Warranty

Hartford Pines Pty Ltd (ACN 080 687 734) trading as Lincoln Pool Equipment (www.linc.com.au) warrants to the purchaser of the PoolCleaner (the product) that if any part thereof proves to be defective in workmanship or material in normal domestic use within three (3) years from date of original purchase, such defective part will be replaced free of charge.

This warranty excludes damage caused by misuse contrary to the operating instructions, neglect, shipping, accident or normal wear and tear. Warranty for the product in commercial use is limited to 6 months. A charge will be made for service outside the warranty period.

The warranty does not cover the cost of transport to and from the retailer or the nearest Lincoln Service Centre.

Proof of Purchase must be retained for all warranty claims.

The rights and remedies conferred by this warranty are in addition to those conferred under the Australian Consumer Law.

The Three-Year Pro Rated Extended Warranty

In addition to its 3 year comprehensive warranty above, Hartford Pines Pty Ltd further warrants the Product's parts, excluding hoses and tyres, will have an operative life of 6 years from the date of purchase when used in accordance with the storage, installation, operation, and maintenance procedures prescribed in the operating instructions provided by us.

If it is found that the Product has not provided the 6 year service life, Hartford Pines will supply, at its discretion, replacement parts for a charge pro rated on the following basis. The original purchaser will be allowed a credit against the current list price of the replacement part(s) in proportion to the percentage of the warranted service life remaining.

Summarized as follows:

Years 1 – 3 ● Unit parts replaced Free of Charge

Years 4 – 6 ● Credit (\$) = Current List Price x (Months of Remaining Life / 72 Months of Warranted Life)

The Extended Three-Year Warranty does not cover labour or the cost of transport to and from the retailer or the nearest Lincoln Service Centre.

Parts not covered by the Extended Three-Year Pro Rated Warranty:

- All types of tyres used on The Pool Cleaner
- All hoses.

The rights and remedies conferred by this warranty are in addition to those conferred under the Australian Consumer Law.

Our goods come with guarantees that cannot be excluded under the Australian Consumer Law. You are entitled to a replacement or refund for a major failure and compensation for any other reasonably foreseeable loss or damage. You are also entitled to have the goods repaired or replaced if the goods fail to be of acceptable quality and the failure does not amount to a major failure.

HOW TO CLAIM

Complete the form below and return it along with the proof of purchase and the product to the retailer from whom it was purchased or the nearest Lincoln Service Centre.

Contact sales@linc.com.au for the nearest location.



REGISTRATION CARD

LINCOLN WARRANTY CLAIM

Owners Name

Address

Telephone

Model Number Date of Purchase

Description of Fault

Attach Proof of purchase

*The Pool Cleaner*TM